

TOILET SLIM Wall fixture

Designer: Manel Lluscà & Carlos Santolaria

Description

Bathroom light for indoor use.

For frontal lighting. Structure material: Aluminium. Structure finish: Chrome. Blades material: . Blades finishes: NA. Diffuser material: Polycarbonate. Diffuser finish: Opal. Warranty: 5 Years.

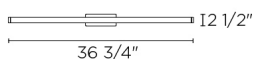

Finish
Chrome
Opal
NA

Material
Aluminium
Polycarbonate



TECHNICAL CHARACTERISTICS

Light source

Light source: LED SAMSUNG
Output (W): 26W
Total power consumption (W): 30.2 W
Color temperature: LED warm-white 3000K
CRI: 90
Photobiological risk: RG1
Real Lumen: 2431
Qty Leds: 132
Lm/Real W: 80
Life Time: 50.000h L80B20
Bin / Grup: VA o VB
MacAdam steps: 3
UGR: 17.9

GEAR

Brand: THOMAS RESEARCH PRODUCTS
Gear included: Yes, electronic
Power Factor: 0.99
Flickering: 30%

Luminaire

Recessed: No
Warranty: 5 Years

Logistics

Energy Efficiency: NA
EAN Code: 8435526854394
Net Weight (Lb): 2.12
Weight in Kg (packaged): 1.700
Packing: 120 x 120 x 1010
Masterbox: 1

The photograph may not match the reference exactly. Please read the product description to identify the finish.

LEDS C4[®]

Luminaire

Code 05-6540-21-M1U
Name APLIQUE TOILET SLIM

Measur.

Code 05-6397-21-M1
Name APLIQUE TOILET SLIM

Luminaire Flux	2431.39 lm	Luminaire Power	32.14 W	Efficacy	75.65 lm/W	Efficiency	100.00%
Lamps Flux	2431.39 lm	Maximum value	157.97 cd/klm	Position	C=75.00 G=10.00	CG	Double Symmetrical
Rectangular Luminaire		Length	28 mm	Width	930 mm	Height	80 mm
Rectangular Luminous Area		Length	28 mm	Width	910 mm	Height	24 mm
Horizontal Luminous Area	0.025480 m2	Emitting area on Plane 180°		Emitting area on Plane 270°		Emitting area on Plane 90°	
Emitting area on Plane 0°	0.000672 m2	Glare area at 76°					
Emitting area on Plane 90°	0.021840 m2						
Coordinate system	CG	Symmetry Type		Maximum Gamma Angle		Measurement Flux	
Date	09-05-2018	Measurement Flux					
Measurement Distance	0.00						
Operator	LEDS	Source Voltage [V]		Source current [A]		Photocell	
Temperature	25.00 °C						
Humidity	60.00 %						
Notes							

Line	Code	Luminaire Lamps	Flux [lm]	Pow. [W]	Q.ty
	05-6540-21-M1U	05-6540-21-M1U	2431.39	32.14	1
C.I.E.	33 60 82 70 100	D DIN 5040	B21		
F UTE	0.70 H + 0.30 T	B NBN	BZ 6		

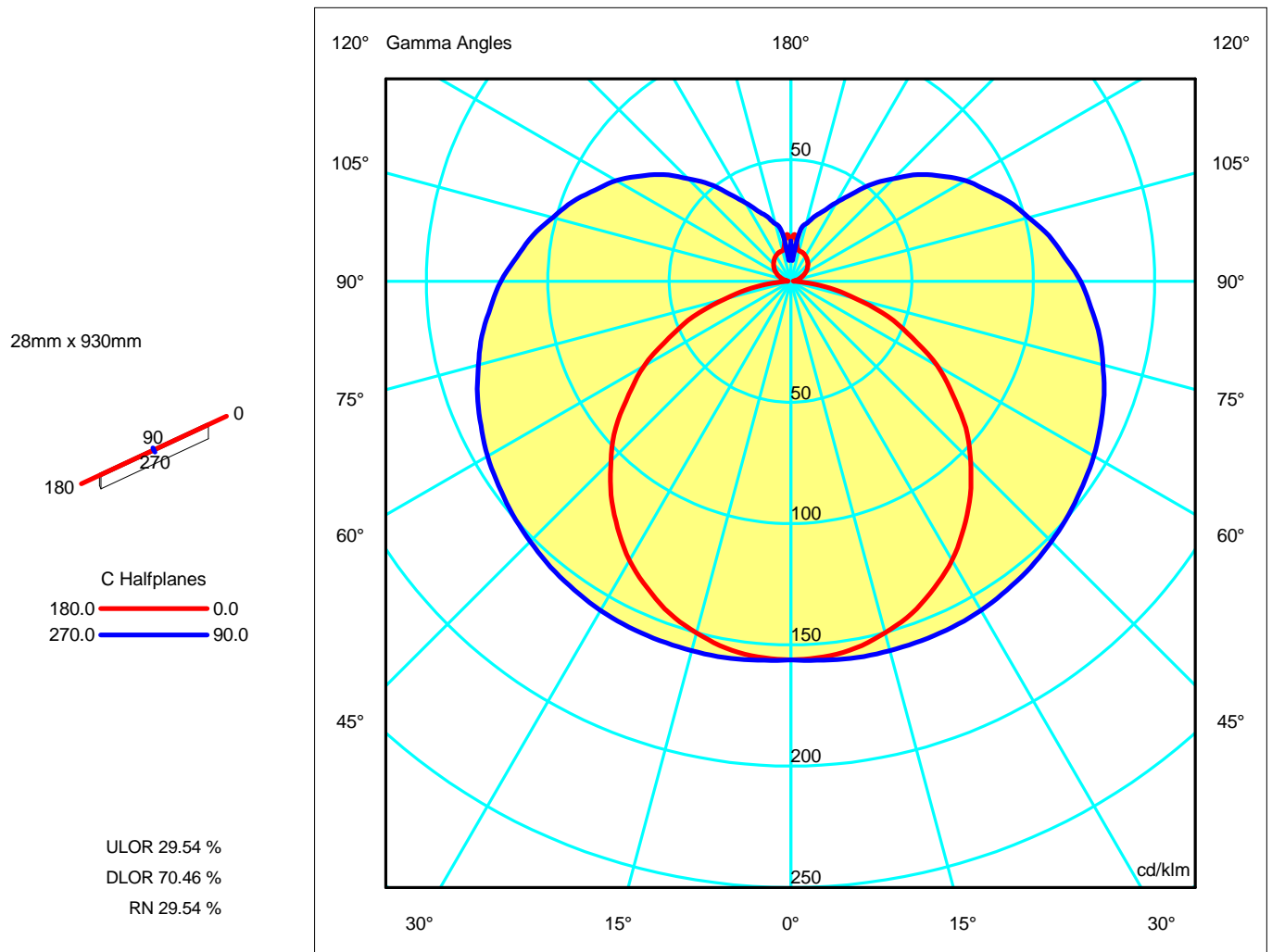

Luminaire

Code 05-6540-21-M1U
Name APLIQUE TOILET SLIM

Measur.

Code 05-6397-21-M1
Name APLIQUE TOILET SLIM

Luminaire Flux	2431.39 lm	Luminaire Power	32.14 W	Efficacy	75.65 lm/W	Efficiency	100.00%
Lamps Flux	2431.39 lm	Maximum value	157.97 cd/klm	Position	C=75.00 G=10.00	CG	Double Symmetrical

Luminous Intensity Table cd/klm Table 1/1

	C 0.00	C 15.00	C 30.00	C 45.00	C 60.00	C 75.00	C 90.00
G 0.0	156.16	156.16	156.16	156.16	156.16	156.16	156.16
G 5.0	155.45	155.68	155.99	156.61	156.68	157.32	156.83
G 10.0	153.61	154.12	155.13	156.38	156.93	157.97	157.55
G 15.0	150.07	151.38	153.08	155.07	156.32	157.87	157.69
G 20.0	145.75	147.43	149.87	152.86	155.20	157.51	157.65
G 25.0	139.66	142.11	145.62	149.93	153.71	156.99	157.41
G 30.0	132.88	135.71	140.36	146.49	151.75	155.93	156.72
G 35.0	124.25	128.20	134.30	142.45	149.06	154.25	155.37
G 40.0	115.09	119.95	127.57	137.59	145.95	152.26	153.85
G 45.0	104.73	110.08	120.62	132.17	142.37	149.85	151.76
G 50.0	94.11	100.14	112.22	126.40	138.50	147.13	149.55
G 55.0	81.34	88.81	104.11	120.38	134.29	144.08	146.86
G 60.0	69.72	78.08	95.06	114.21	130.07	141.00	144.20
G 65.0	55.21	65.90	86.84	108.21	125.69	137.44	140.79
G 70.0	42.70	54.61	78.19	102.30	121.08	133.64	137.33
G 75.0	27.92	43.40	70.99	96.51	116.29	129.32	133.16
G 80.0	16.49	34.09	63.96	90.82	111.57	124.84	129.14
G 85.0	5.61	26.60	58.04	85.50	106.40	120.01	124.11
G 90.0	1.22	22.00	52.81	80.28	101.32	114.90	119.39
G 95.0	1.50	19.15	48.56	75.25	95.84	109.27	113.34
G100.0	2.31	18.00	44.84	70.46	90.60	103.74	107.97
G105.0	3.48	16.69	42.13	65.98	85.05	97.56	101.43
G110.0	4.55	15.57	39.27	61.82	79.81	91.89	95.73
G115.0	5.82	14.99	36.29	57.88	74.36	85.39	88.87
G120.0	6.91	15.20	32.93	52.92	68.97	79.55	82.98
G125.0	8.09	15.65	29.94	48.00	62.62	72.46	75.50
G130.0	9.04	16.18	27.20	42.70	56.21	65.40	68.37
G135.0	10.02	16.76	25.65	37.81	49.30	57.27	59.70
G140.0	10.77	17.34	24.49	33.06	43.01	49.94	52.32
G145.0	11.51	17.73	23.52	30.18	36.68	42.08	43.85
G150.0	12.07	16.94	21.91	27.20	32.39	36.00	37.39
G155.0	12.58	15.20	18.92	24.07	28.61	31.24	31.96
G160.0	12.86	13.91	15.39	20.69	24.40	27.45	28.26
G165.0	12.99	13.67	13.49	17.00	19.97	22.16	24.46
G170.0	15.05	15.49	15.31	14.75	16.10	18.96	20.33
G175.0	19.30	18.65	19.16	16.59	15.12	14.03	8.65
G180.0	16.52	16.52	16.52	16.52	16.52	16.52	16.52

LEDS C4[®]

Luminaire

Code 05-6540-21-M1U
Name APLIQUE TOILET SLIM

Measur.

Code 05-6397-21-M1
Name APLIQUE TOILET SLIM

Luminaire Flux	2431.39 lm	Luminaire Power	32.14 W	Efficacy	75.65 lm/W	Efficiency	100.00%
Lamps Flux	2431.39 lm	Maximum value	157.97 cd/klm	Position	C=75.00 G=10.00	CG	Double Symmetrical

28mm x 930mm

C Halfplanes

180.0 ——— 0.0
270.0 ——— 90.0

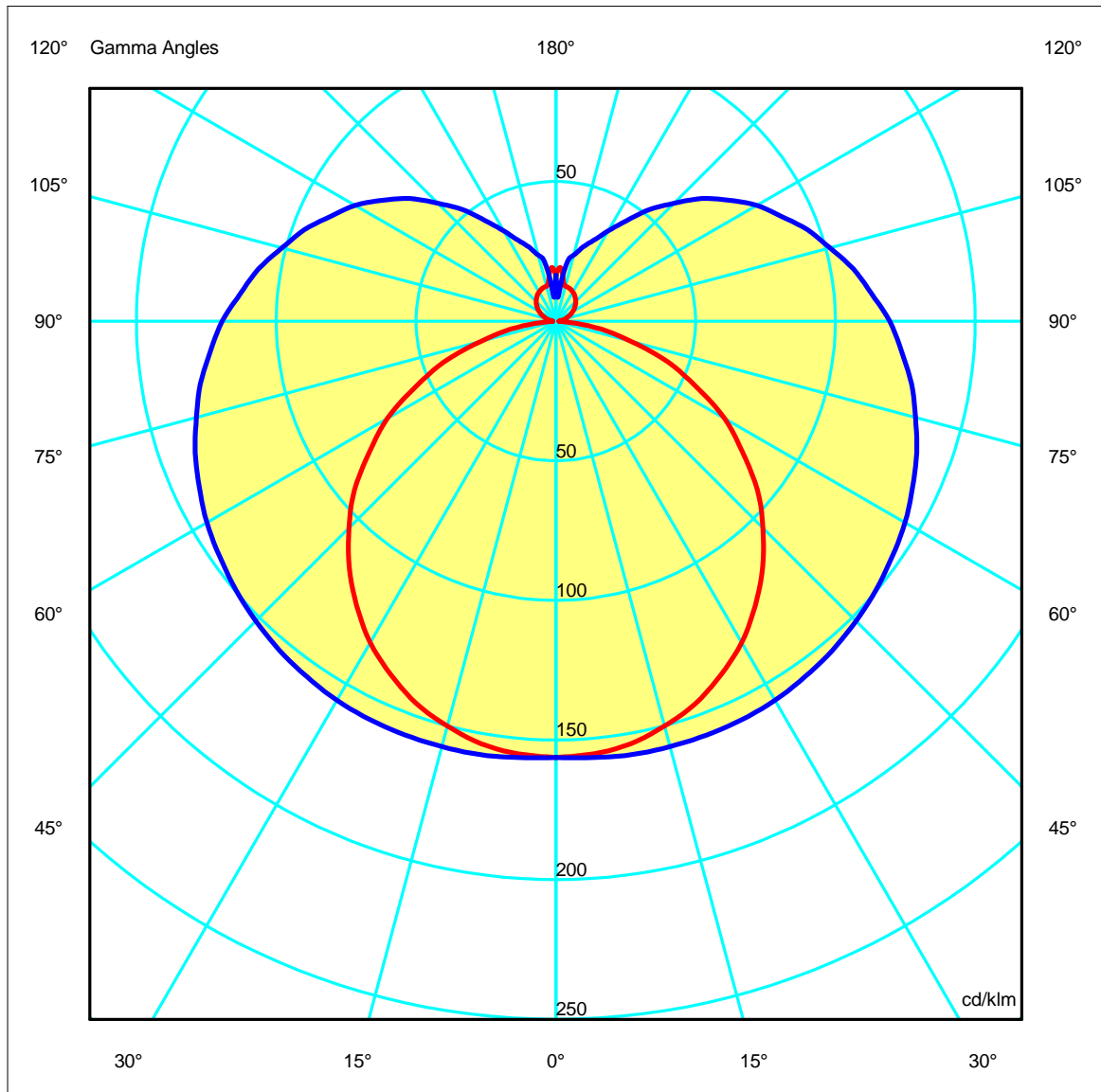
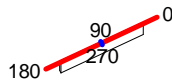

Luminaire

Code 05-6540-21-M1U
Name APLIQUE TOILET SLIM

Measurem.

Code 05-6397-21-M1
Name APLIQUE TOILET SLIM

Luminaire Flux	2431.39 lm	Luminaire Power	32.14 W	Efficacy	75.65 lm/W	Efficiency	100.00%
Lamps Flux	2431.39 lm	Maximum value	157.97 cd/klm	Position	C=75.00 G=10.00	CG	Double Symmetrical

Could not find 90270 right beam angle•gamma0180=0

Could not find 90270 right beam angle•gamma0180=0

Could not find 90270 right beam angle•gamma0180=0

Luminaire

Code 05-6540-21-M1U
Name APLIQUE TOILET SLIM

Measurement

Code 05-6397-21-M1
Name APLIQUE TOILET SLIM

Luminaire Flux	2431.39 lm	Luminaire Power	32.14 W	Efficacy	75.65 lm/W	Efficiency	100.00%
Lamps Flux	2431.39 lm	Maximum value	157.97 cd/klm	Position	C=75.00 G=10.00	CG	Double Symmetrical

UGR
S = 0.250

Reflectancies										
Ceiling/Cavity	0.7	0.7	0.5	0.5	0.3	0.7	0.7	0.5	0.5	0.3
Walls	0.5	0.3	0.5	0.3	0.3	0.5	0.3	0.5	0.3	0.3
WorkingPlane	0.2	0.2	0.2	0.2	0.2	0.2	0.2	0.2	0.2	0.2
RoomDimensions	Viewed Crosswise					Viewed Endwise				
x=2H y=2H	17.9	19.0	18.6	19.7	20.5	19.4	20.6	20.1	21.3	22.1
x=2H y=3H	19.4	20.4	20.1	21.2	22.0	22.0	23.0	22.7	23.7	24.6
x=2H y=4H	20.0	21.0	20.7	21.7	22.6	23.3	24.2	24.0	25.0	25.8
x=2H y=6H	20.4	21.3	21.2	22.1	23.0	24.6	25.5	25.3	26.2	27.1
x=2H y=8H	20.5	21.4	21.3	22.2	23.1	25.2	26.1	26.0	26.8	27.7
x=2H y=12H	20.6	21.4	21.4	22.2	23.1	25.8	26.7	26.6	27.4	28.4
x=4H y=2H	19.0	20.0	19.7	20.7	21.6	20.1	21.1	20.8	21.8	22.7
x=4H y=3H	20.8	21.6	21.6	22.4	23.3	22.9	23.7	23.6	24.5	25.4
x=4H y=4H	21.6	22.3	22.3	23.1	24.1	24.3	25.1	25.1	25.9	26.8
x=4H y=6H	22.1	22.8	22.9	23.6	24.6	25.8	26.5	26.6	27.3	28.3
x=4H y=8H	22.3	22.9	23.1	23.7	24.7	26.6	27.2	27.4	28.0	29.0
x=4H y=12H	22.4	23.0	23.3	23.8	24.8	27.3	27.9	28.1	28.7	29.7
x=8H y=4H	22.5	23.1	23.3	24.0	25.0	24.7	25.3	25.5	26.2	27.2
x=8H y=6H	23.4	24.0	24.3	24.8	25.8	26.5	27.0	27.3	27.8	28.9
x=8H y=8H	23.8	24.3	24.7	25.1	26.2	27.4	27.8	28.2	28.7	29.7
x=8H y=12H	24.1	24.5	24.9	25.3	26.4	28.3	28.7	29.2	29.6	30.7
x=12H y=4H	22.8	23.3	23.6	24.2	25.2	24.7	25.3	25.6	26.2	27.2
x=12H y=6H	23.9	24.3	24.7	25.2	26.2	26.6	27.0	27.4	27.9	28.9
x=12H y=8H	24.4	24.8	25.3	25.7	26.7	27.6	28.0	28.4	28.9	29.9

LEDS C4[®]

Luminaire

Code 05-6540-21-M1U
Name APLIQUE TOILET SLIM

Measur.

Code 05-6397-21-M1
Name APLIQUE TOILET SLIM

Luminaire Flux	2431.39 lm	Luminaire Power	32.14 W	Efficacy	75.65 lm/W	Efficiency	100.00%
Lamps Flux	2431.39 lm	Maximum value	157.97 cd/klm	Position	C=75.00 G=10.00	CG	Double Symmetrical

28mm x 930mm

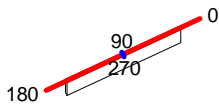

C Halfplanes

180.0 ———— 0.0
270.0 ———— 90.0

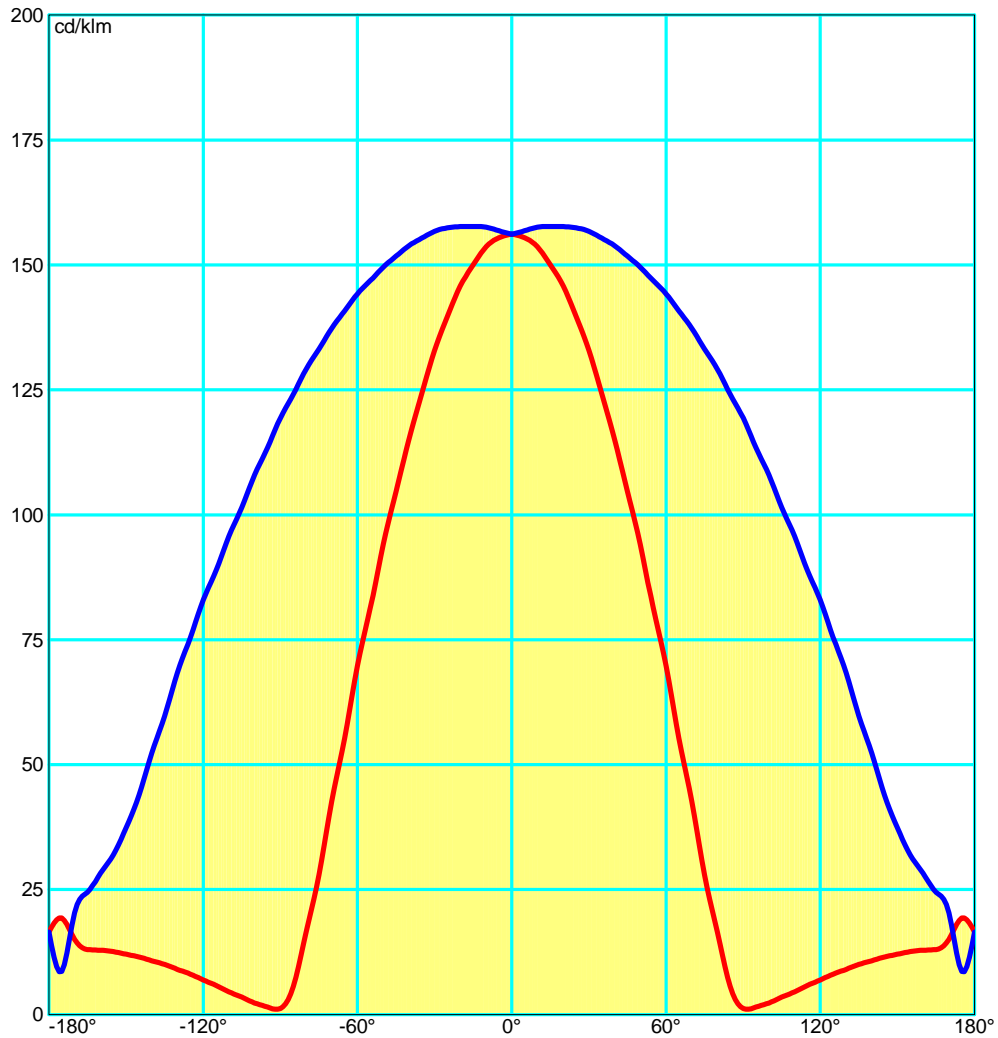

LEDS C4[®]

Luminaire

Code 05-6540-21-M1U
 Name APLIQUE TOILET SLIM

Measur.

Code 05-6397-21-M1
 Name APLIQUE TOILET SLIM

Luminaire Flux	2431.39 lm	Luminaire Power	32.14 W	Efficacy	75.65 lm/W	Efficiency	100.00%
Lamps Flux	2431.39 lm	Maximum value	157.97 cd/klm	Position	C=75.00 G=10.00	CG	Double Symmetrical

Luminance

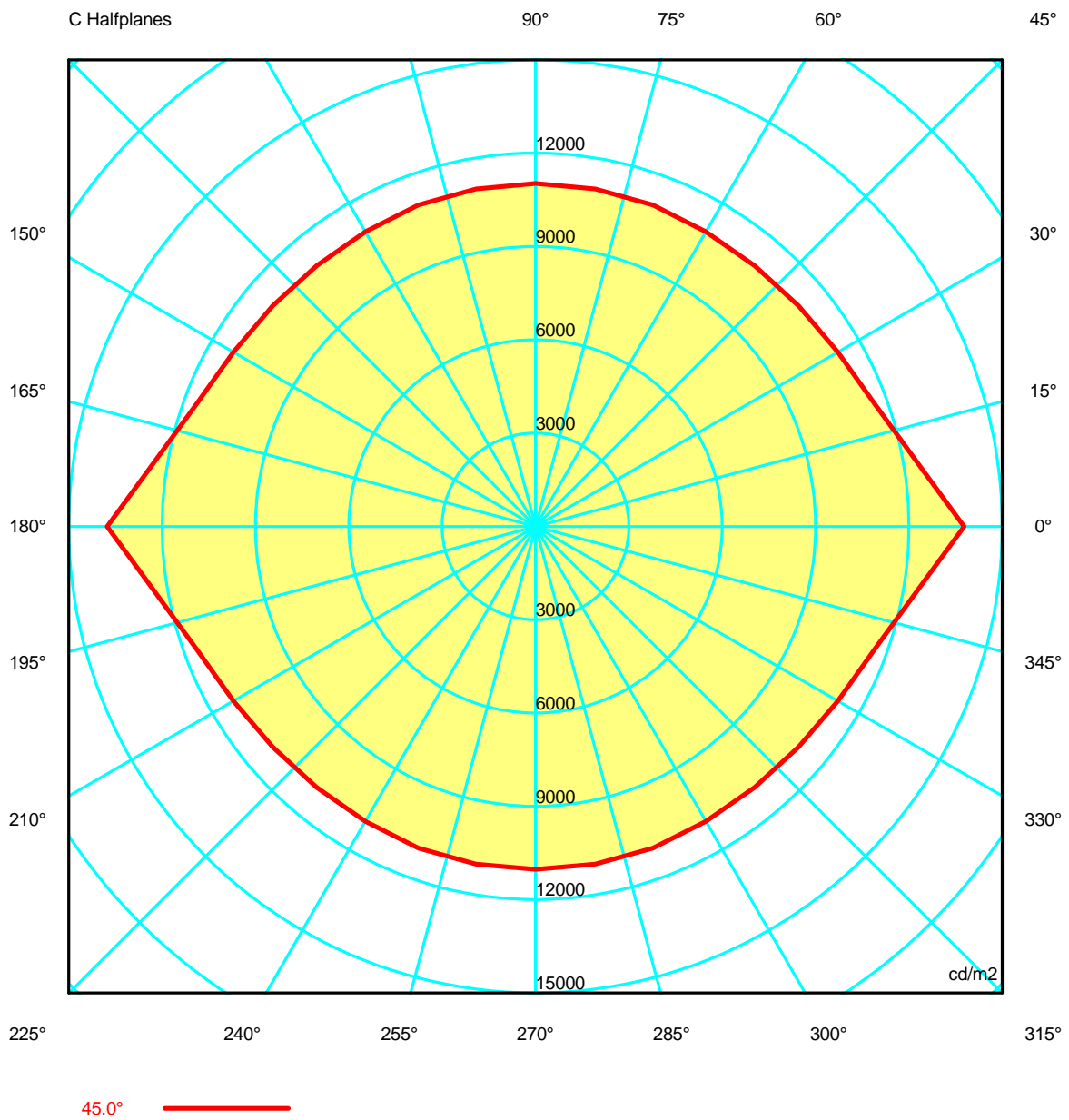

Luminaire

Code 05-6540-21-M1U
Name APLIQUE TOILET SLIM

Measurum.

Code 05-6397-21-M1
Name APLIQUE TOILET SLIM

Luminaire Flux	2431.39 lm	Luminaire Power	32.14 W	Efficacy	75.65 lm/W	Efficiency	100.00%
Lamps Flux	2431.39 lm	Maximum value	157.97 cd/klm	Position	C=75.00 G=10.00	CG	Double Symmetrical

Luminance cd/m2 Table 1/3

	C 0.00	C 10.00	C 20.00	C 30.00	C 40.00	C 50.00	C 60.00	C 70.00	C 80.00	C 90.00	C 100.00	C 110.00	C 120.00
G 0.0	14901.29	14901.29	14901.29	14901.29	14901.29	14901.29	14901.29	14901.29	14901.29	14901.29	14901.29	14901.29	14901.29
G 5.0	14855.89	14680.92	14514.99	14374.46	14273.20	14169.09	14077.47	14051.88	14024.98	13974.50	14024.98	14051.88	14077.47
G 10.0	14815.48	14467.81	14165.60	13923.22	13735.91	13561.24	13418.43	13361.02	13315.81	13261.76	13315.81	13361.02	13418.43
G 15.0	14721.40	14241.96	13826.63	13490.94	13234.63	13013.90	12843.08	12768.57	12716.17	12668.38	12716.17	12768.57	12843.08
G 20.0	14659.96	14016.48	13482.52	13071.08	12770.89	12532.63	12361.26	12289.86	12223.81	12202.22	12223.81	12289.86	12361.26
G 25.0	14525.85	13747.54	13125.05	12665.66	12347.94	12117.40	11967.47	11914.13	11852.85	11840.84	11852.85	11914.13	11967.47
G 30.0	14421.41	13474.46	12756.15	12268.44	11970.04	11769.48	11642.32	11604.87	11550.54	11551.52	11550.54	11604.87	11642.32
G 35.0	14211.60	13153.13	12378.97	11887.59	11630.21	11464.94	11356.60	11341.90	11325.59	11310.40	11325.59	11341.90	11356.60
G 40.0	14025.47	12832.87	12007.80	11525.20	11306.72	11190.08	11126.96	11144.48	11147.05	11147.00	11147.05	11144.48	11126.96
G 45.0	13769.81	12384.04	11581.94	11215.28	11030.33	10946.62	10944.48	11001.92	11020.51	11027.82	11020.51	11001.92	10944.48
G 50.0	13545.18	11990.69	11147.92	10831.81	10755.79	10765.31	10819.11	10916.20	10958.44	10982.16	10958.44	10916.20	10819.11
G 55.0	13041.68	11392.83	10665.06	10531.60	10551.24	10627.03	10746.73	10887.96	10950.54	10984.89	10950.54	10887.96	10746.73
G 60.0	12724.47	10915.65	10203.04	10181.43	10364.51	10565.07	10752.99	10940.62	11027.82	11075.85	11027.82	10940.62	10752.99
G 65.0	11798.59	10075.11	9667.03	9962.49	10295.73	10578.19	10831.44	11053.64	11150.10	11200.47	11150.10	11053.64	10831.44
G 70.0	11107.56	9334.04	9152.82	9738.29	10290.09	10686.10	10983.26	11239.51	11356.13	11419.96	11356.13	11239.51	10983.26
G 75.0	9370.05	8259.41	8718.04	9748.73	10439.45	10883.00	11224.62	11501.37	11621.86	11692.26	11621.86	11501.37	11224.62
G 80.0	7881.31	7438.56	8467.24	9873.12	10708.76	11220.07	11601.55	11880.37	12004.99	12108.18	12004.99	11880.37	11601.55
G 85.0	4716.77	6755.63	8603.93	10316.06	11221.39	11724.17	12090.69	12379.76	12499.47	12585.30	12499.47	12379.76	12090.69
G 90.0	4402.73	7655.69	9484.87	11162.73	12008.92	12466.67	12796.73	13055.93	13169.87	13291.75	13169.87	13055.93	12796.73

Luminaire

Code 05-6540-21-M1U
Name APLIQUE TOILET SLIM

Measur.

Code 05-6397-21-M1
Name APLIQUE TOILET SLIM

Luminaire Flux	2431.39 lm	Luminaire Power	32.14 W	Efficacy	75.65 lm/W	Efficiency	100.00%
Lamps Flux	2431.39 lm	Maximum value	157.97 cd/klm	Position	C=75.00 G=10.00	CG	Double Symmetrical

Luminance cd/m2 Table 2/3

	C 130.00	C 140.00	C 150.00	C 160.00	C 170.00	C 180.00	C 190.00	C 200.00	C 210.00	C 220.00	C 230.00	C 240.00	C 250.00
G 0.0	14901.29	14901.29	14901.29	14901.29	14901.29	14901.29	14901.29	14901.29	14901.29	14901.29	14901.29	14901.29	14901.29
G 5.0	14169.09	14273.20	14374.46	14514.99	14680.92	14855.89	14680.92	14514.99	14374.46	14273.20	14169.09	14077.47	14051.88
G 10.0	13561.24	13735.91	13923.22	14165.60	14467.81	14815.48	14467.81	14165.60	13923.22	13735.91	13561.24	13418.43	13361.02
G 15.0	13013.90	13234.63	13490.94	13826.63	14241.96	14721.40	14241.96	13826.63	13490.94	13234.63	13013.90	12843.08	12768.57
G 20.0	12532.63	12770.89	13071.08	13482.52	14016.48	14659.96	14016.48	13482.52	13071.08	12770.89	12532.63	12361.26	12289.86
G 25.0	12117.40	12347.94	12665.66	13125.05	13747.54	14525.85	13747.54	13125.05	12665.66	12347.94	12117.40	11967.47	11914.13
G 30.0	11769.48	11970.04	12268.44	12756.15	13474.46	14421.41	13474.46	12756.15	12268.44	11970.04	11769.48	11642.32	11604.87
G 35.0	11464.94	11630.21	11887.59	12378.97	13153.13	14211.60	13153.13	12378.97	11887.59	11630.21	11464.94	11356.60	11341.90
G 40.0	11190.08	11306.72	11525.20	12007.80	12832.87	14025.47	12832.87	12007.80	11525.20	11306.72	11190.08	11126.96	11144.48
G 45.0	10946.62	11030.33	11215.28	11581.94	12384.04	13769.81	12384.04	11581.94	11215.28	11030.33	10946.62	10944.48	11001.92
G 50.0	10765.31	10755.79	10831.81	11147.92	11990.69	13545.18	11990.69	11147.92	10831.81	10755.79	10765.31	10819.11	10916.20
G 55.0	10627.03	10551.24	10531.60	10665.06	11392.83	13041.68	11392.83	10665.06	10531.60	10551.24	10627.03	10746.73	10887.96
G 60.0	10565.07	10364.51	10181.43	10203.04	10915.65	12724.47	10915.65	10203.04	10181.43	10364.51	10565.07	10752.99	10940.62
G 65.0	10578.19	10295.73	9962.49	9667.03	10075.11	11798.59	10075.11	9667.03	9962.49	10295.73	10578.19	10831.44	11053.64
G 70.0	10686.10	10290.09	9738.29	9152.82	9334.04	11107.56	9334.04	9152.82	9738.29	10290.09	10686.10	10983.26	11239.51
G 75.0	10883.00	10439.45	9748.73	8718.04	8259.41	9370.05	8259.41	8718.04	9748.73	10439.45	10883.00	11224.62	11501.37
G 80.0	11220.07	10708.76	9873.12	8467.24	7438.56	7881.31	7438.56	8467.24	9873.12	10708.76	11220.07	11601.55	11880.37
G 85.0	11724.17	11221.39	10316.06	8603.93	6755.63	4716.77	6755.63	8603.93	10316.06	11221.39	11724.17	12090.69	12379.76
G 90.0	12466.67	12008.92	11162.73	9484.87	7655.69	4402.73	7655.69	9484.87	11162.73	12008.92	12466.67	12796.73	13055.93

Luminaire

Code 05-6540-21-M1U
Name APLIQUE TOILET SLIM

Measur.

Code 05-6397-21-M1
Name APLIQUE TOILET SLIM

Luminaire Flux	2431.39 lm	Luminaire Power	32.14 W	Efficacy	75.65 lm/W	Efficiency	100.00%
Lamps Flux	2431.39 lm	Maximum value	157.97 cd/klm	Position	C=75.00 G=10.00	CG	Double Symmetrical

Luminance cd/m2 Table 3/3

	C 260.00	C 270.00	C 280.00	C 290.00	C 300.00	C 310.00	C 320.00	C 330.00	C 340.00	C 350.00
G 0.0	14901.29	14901.29	14901.29	14901.29	14901.29	14901.29	14901.29	14901.29	14901.29	14901.29
G 5.0	14024.98	13974.50	14024.98	14051.88	14077.47	14169.09	14273.20	14374.46	14514.99	14680.92
G 10.0	13315.81	13261.76	13315.81	13361.02	13418.43	13561.24	13735.91	13923.22	14165.60	14467.81
G 15.0	12716.17	12668.38	12716.17	12768.57	12843.08	13013.90	13234.63	13490.94	13826.63	14241.96
G 20.0	12223.81	12202.22	12223.81	12289.86	12361.26	12532.63	12770.89	13071.08	13482.52	14016.48
G 25.0	11852.85	11840.84	11852.85	11914.13	11967.47	12117.40	12347.94	12665.66	13125.05	13747.54
G 30.0	11550.54	11551.52	11550.54	11604.87	11642.32	11769.48	11970.04	12268.44	12756.15	13474.46
G 35.0	11325.59	11310.40	11325.59	11341.90	11356.60	11464.94	11630.21	11887.59	12378.97	13153.13
G 40.0	11147.05	11147.00	11147.05	11144.48	11126.96	11190.08	11306.72	11525.20	12007.80	12832.87
G 45.0	11020.51	11027.82	11020.51	11001.92	10944.48	10946.62	11030.33	11215.28	11581.94	12384.04
G 50.0	10958.44	10982.16	10958.44	10916.20	10819.11	10765.31	10755.79	10831.81	11147.92	11990.69
G 55.0	10950.54	10984.89	10950.54	10887.96	10746.73	10627.03	10551.24	10531.60	10665.06	11392.83
G 60.0	11027.82	11075.85	11027.82	10940.62	10752.99	10565.07	10364.51	10181.43	10203.04	10915.65
G 65.0	11150.10	11200.47	11150.10	11053.64	10831.44	10578.19	10295.73	9962.49	9667.03	10075.11
G 70.0	11356.13	11419.96	11356.13	11239.51	10983.26	10686.10	10290.09	9738.29	9152.82	9334.04
G 75.0	11621.86	11692.26	11621.86	11501.37	11224.62	10883.00	10439.45	9748.73	8718.04	8259.41
G 80.0	12004.99	12108.18	12004.99	11880.37	11601.55	11220.07	10708.76	9873.12	8467.24	7438.56
G 85.0	12499.47	12585.30	12499.47	12379.76	12090.69	11724.17	11221.39	10316.06	8603.93	6755.63
G 90.0	13169.87	13291.75	13169.87	13055.93	12796.73	12466.67	12008.92	11162.73	9484.87	7655.69

Luminaire
 Code 05-6540-21-M1U
 Name APLIQUE TOILET SLIM
Measurment.
 Code 05-6397-21-M1
 Name APLIQUE TOILET SLIM

Luminaire Flux	2431.39 lm	Luminaire Power	32.14 W	Efficacy	75.65 lm/W	Efficiency	100.00%
Lamps Flux	2431.39 lm	Maximum value	157.97 cd/klm	Position	C=75.00 G=10.00	CG	Double Symmetrical

PERCENTAGE ISOCANDLES

Projection: Equal Area SLI 6.9 Tight Tilting Angle:0°

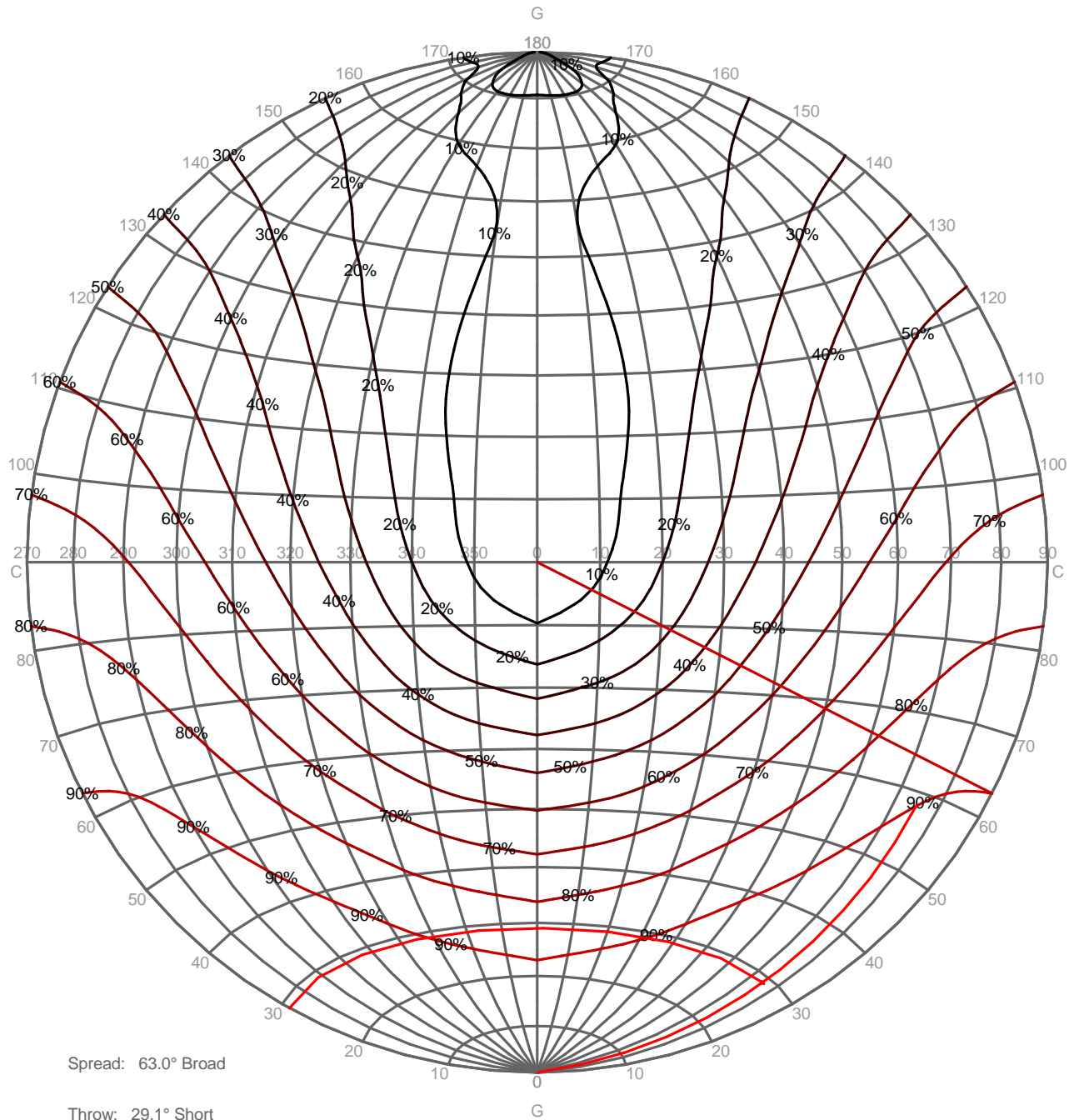

LEDS C4[®]

Luminaire

Code 05-6540-21-M1U
 Name APLIQUE TOILET SLIM

Measur.

Code 05-6397-21-M1
 Name APLIQUE TOILET SLIM

Luminaire Flux	2431.39 lm	Luminaire Power	32.14 W	Efficacy	75.65 lm/W	Efficiency	100.00%
Lamps Flux	2431.39 lm	Maximum value	157.97 cd/klm	Position	C=75.00 G=10.00	CG	Double Symmetrical

Isolux (Floor)

Luminaire position X=0.00m Y=0.00m Z=2.50m

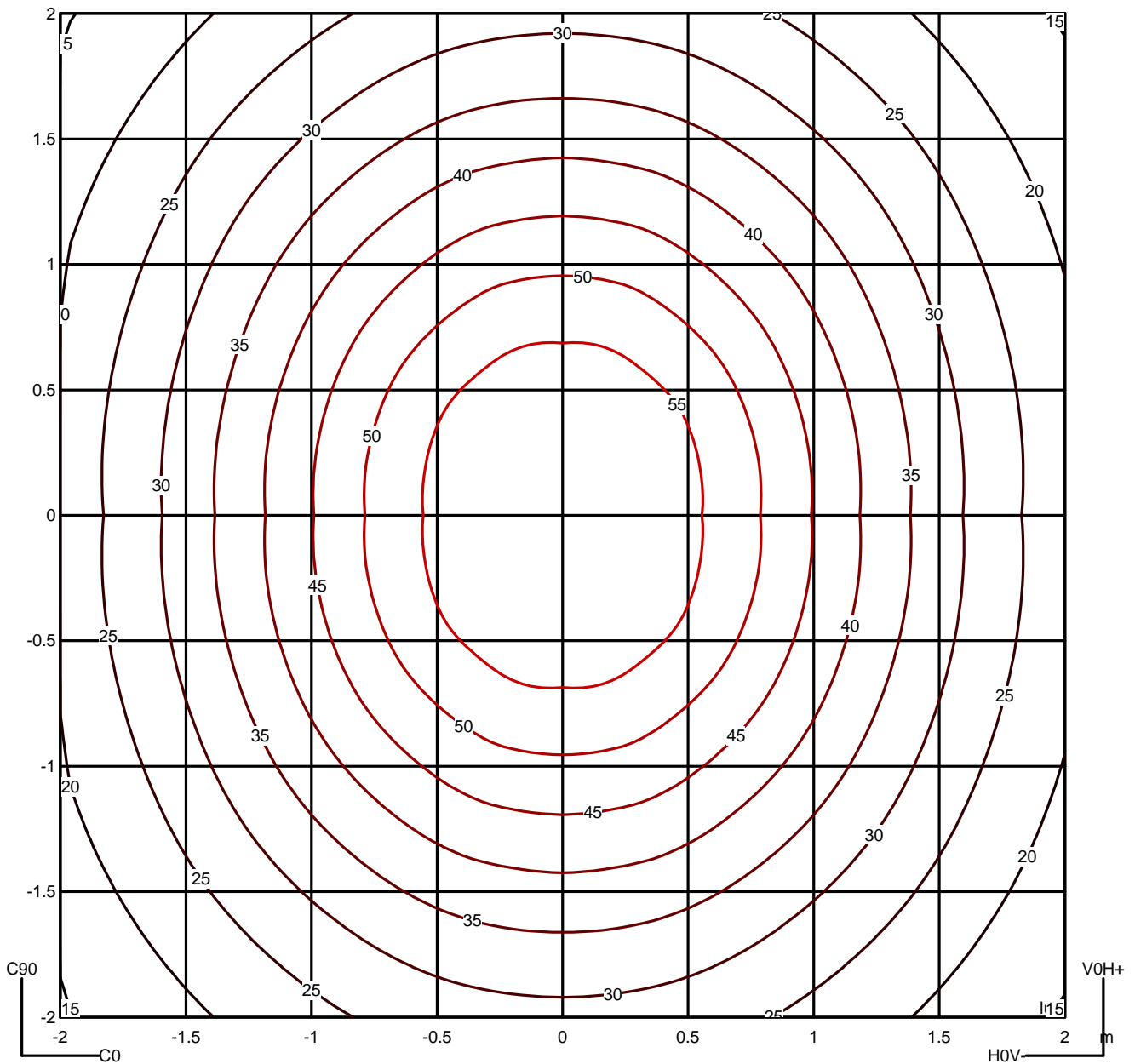

LEDS C4[®]

Luminaire

Code 05-6540-21-M1U
Name APLIQUE TOILET SLIM

Measur.

Code 05-6397-21-M1
Name APLIQUE TOILET SLIM

Luminaire Flux	2431.39 lm	Luminaire Power	32.14 W	Efficacy	75.65 lm/W	Efficiency	100.00%
Lamps Flux	2431.39 lm	Maximum value	157.97 cd/klm	Position	C=75.00 G=10.00	CG	Double Symmetrical

		Average Luminance [cd/m ²]									
		45°	50°	55°	60°	65°	70°	75°	80°	85°	
0.0°	13770	13545	13042	12724	11799	11108	9370	7881	4717	---	
90.0°	11028	10982	10985	11076	11200	11420	11692	12108	12585	---	

Flush mounted or longitudinal view												
		Illumination(Ix)										
A	A	2000	1000	750	500		<300				1.15	
B	1		2000	1500	1000	750	500	<300			1.5	
C					2000		1000	500	<300		1.85	
D	2						2000	1000	500	<300	2.2	
E	3							2000	1000	500	<300	2.55

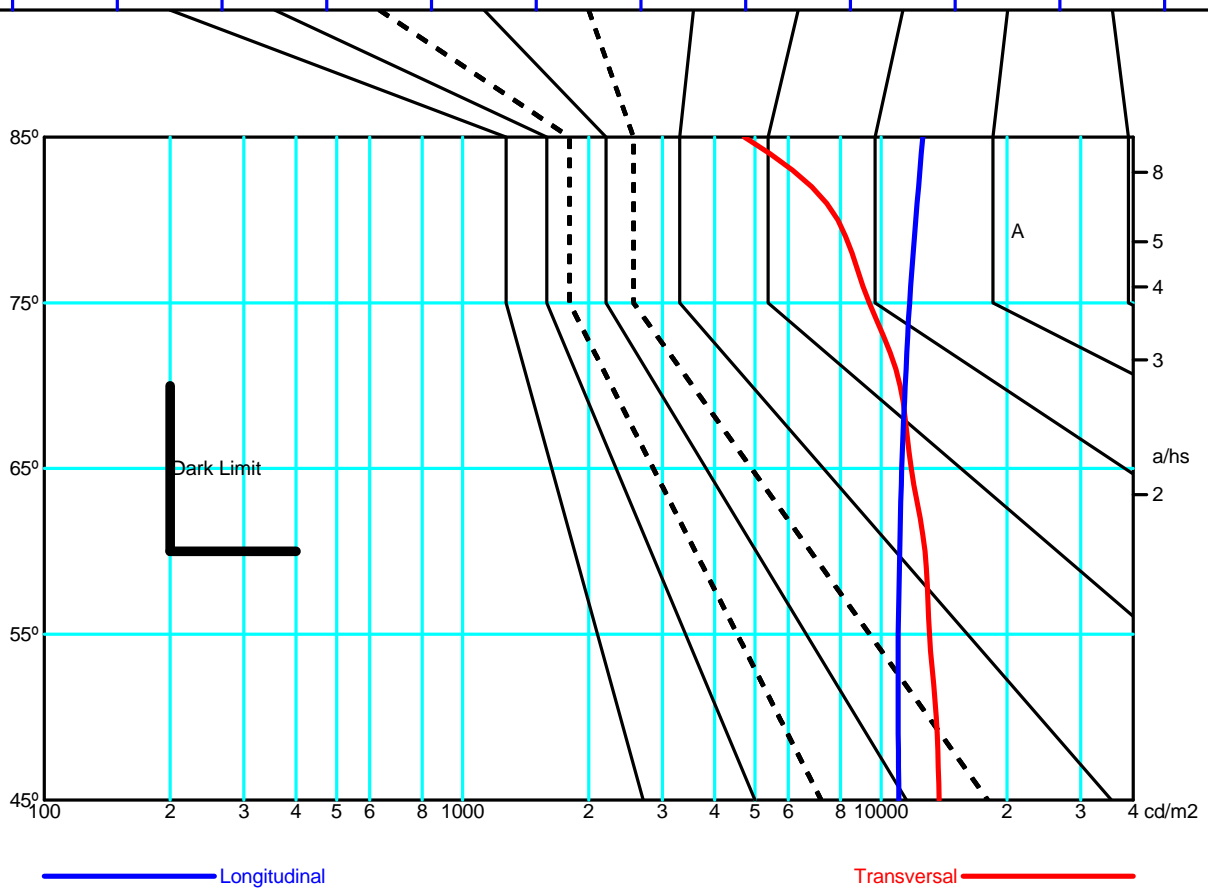
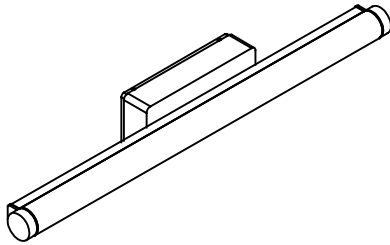

FIGURE N° 1. UNPACK THE FIXTURE: CHECK THE CONTENTS OF THE BOX. YOU SHOULD RECEIVE:

FIGURE N° 1. DÉBALLER LE PLAFONIER: VÉRIFIER LE CONTENU DU CARTON, VOUS DEVEZ RECEVOIR:

BOX 1

(1)A



(1)B

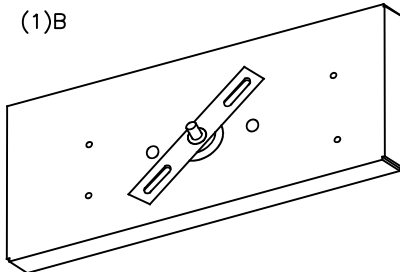

OUTLET BOX
Boîte de distribution

WALL
Mur

FIGURE 6

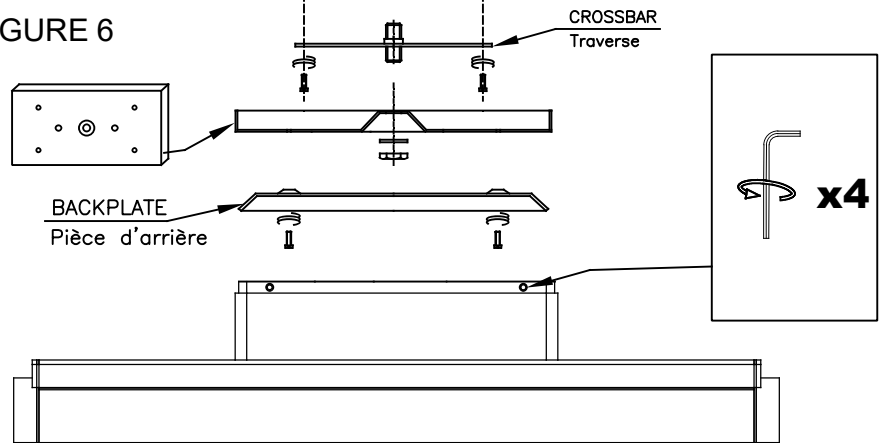
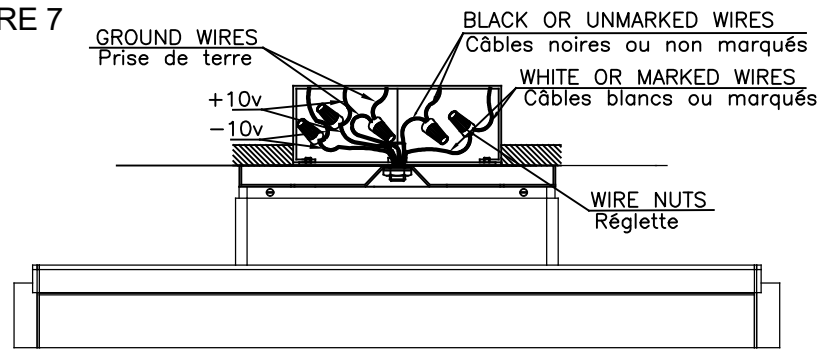

FIGURE 7



INSTALLATION INSTRUCTIONS FOR HANGING FIXTURES

INSTRUCTIONS D'INSTALLATION POUR PLAFONNIERS

FIGURE 3, 4 AND 5 MOUNTING HARDWARE.
NOTE: TEST THE CONNECTOR BY GENTLY PULLING IT. IF IT PULLS OUT THE CONNECTION, TRY AGAIN TILL YOU HAVE A FIRM CONNECTION. MAKE SURE NO BARE STRANDS OF WIRE STICK OUT FROM UNDER THE CONNECTORS.

FIGURE 3, 4 ET 5 MONTAGE DE L'ÉQUIPE.
IMPORTANT: ESSAYER DE TIRER LE CÂBLE D'ALIMENTATION DOUCEMENT. S'IL SORT DE LA CONNECTION, IL FAUDRAIT ASSURER QUE LA CONNECTION SOIT FERME. S'ASSURER QUE LES FILS DES CÂBLES NE SONT PAS À DÉCOUVERT DU CONNECTEUR.

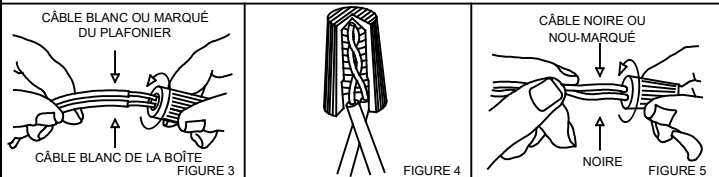
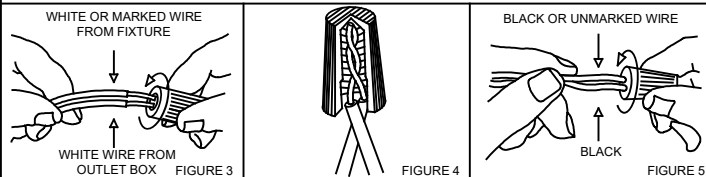

CAUTION:
"Warning", "This product is to be installed by a qualified electrician only."
"Suitable for dry and damp locations only"

ATTENTION:
"Attention", le raccordement électrique sera effectué par un technicien électrique qualifié"
"convenient aux emplacements humides"

CAUTION:
1.- Wrong lighting installation can be dangerous for your safety.
2.- Before starting, disconnect the power by turning off the general switch of the electric installation.
3.- Install light bulbs (not provided) that must not exceed markings on the fixture.
4.- To change the bulbs, disconnect the power by turning off the general switch and wait for the bulbs cool down.
INSTALLATION:
1.- Make electrical connections, carefully read the Electrical Connection section.
2.- Assemble lighting onto the outlet box as shown on fig. 6, & 7.
ELECTRICAL CONNECTIONS: (See fig. 3,4 y 5)
1.- Connect the white wire from the fixture to the white wire of the electric installation.
2.- Connect the black wire from the fixture to the black wire of the electric installation.
3.- Connect the grounding conductor from the fixture to the grounding wire of the electric installation.
4.- Spread out the electrical wires so that the black ones are on one side of the outlet box and the white ones are on the other side, and carefully introduce them into the outlet box.

ATTENTION:
1. Une mauvaise installation peut compromettre votre sécurité.
2. Déconnecter la tension du réseau d'alimentation avant de réaliser toute opération.
3. Installer les ampoules (non fournies), ne pas utiliser d'ampoules d'un autre type ou d'une puissance supérieure à celle indiquée sur l'étiquette de la lampe.
4. Pour changer les ampoules, déconnecter la tension du réseau d'alimentation et laisser refroidir les ampoules.
INSTALLATION:
1. Connecter au réseau, lire attentivement la section de "Raccordements électriques"
2. Installer l'appareil à la boîte de distribution comme indiqué dans les dessins 6 et 7.
RACCORDEMENTS ÉLECTRIQUES (dessins 3,4 et 5)
1. Connecter le câble blanc de l'appareil au câble blanc de l'installation électrique.
2. Connecter le câble noir de l'appareil au câble noir de l'installation électrique.
3. Connecter le câble conducteur de prise de terre au câble de prise de terre de l'installation électrique.
4. Distribuer les câbles pour que tout le câblage noir soit par dehors et le câblage blanc soit par dedans. Ajuster et immobiliser à la boîte sans coincer aucun câble.