

55-1573-N3-00

V0

STEP Signal



Description

Signal lighting/light for indoor use.

For frontal lighting and downlighting. Compact, high performance product. Structure material: Aluminium. Structure finish: Grey. Warranty: 5 Years.

Finish
Grey

Material
Aluminium

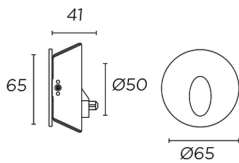

TECHNICAL CHARACTERISTICS

Light source

Light source: LED
Output (W): 2W
Total power consumption (W): 2,7
Color temperature: Warm White - 3000K
Real Lumen: 67
Nominal Lumen: 158
Qty Leds: 1
Lm/Real W: 25
Life Time: 50.000h L80B20
Bin / Grup: VB
MacAdam steps: 3
UGR: 6.1

GEAR

Gear included: Yes, electronic
Voltage / Frequency:
220-240VAC/50-60Hz
Power Factor: 0.96

Luminaire

Warranty: 5 Years

Logistics

Energy Efficiency: LED A++
Net Weight (Kg): 0.000
Masterbox: 10

The photograph may not match the reference exactly. Please read the product description to identify the finish.

Report No.: 003

Test Time: 2013-03-01 16:19

Luminaire Property

Luminaire Category: Step Light
 Luminaire Manufacturer: Leds-C4
 Lamp Description: SAMSUNG
 Lumens per Lamp: 158
 Luminous Width (mm):
 Voltage: 220 V
 Power: 2.00 W

Luminaire Description: 55-1573
 Lamp Catalog: LED
 Number of Lamps: 1
 Luminous Length (mm):
 Luminous Height (mm):
 Current: 0.012 A
 Power Factor: 0.768

Photometric Results

CIE Class: Direct
 Measurement Flux: 67 lm
 Downward Ratio: 39.18%
 Luminaire Efficacy Rating (LER): 33
 Max. Intensity: 59.25 cd

Total Rated Lamp Lumens: 158.0 lm
 Efficiency: 42.38%
 Upward Ratio: 3.19%
 Central Intensity: 15.89 cd
 Pos of Max. Intensity: H90 V34

Picture Of Luminaire



Luminous Intensity Distribution Curve

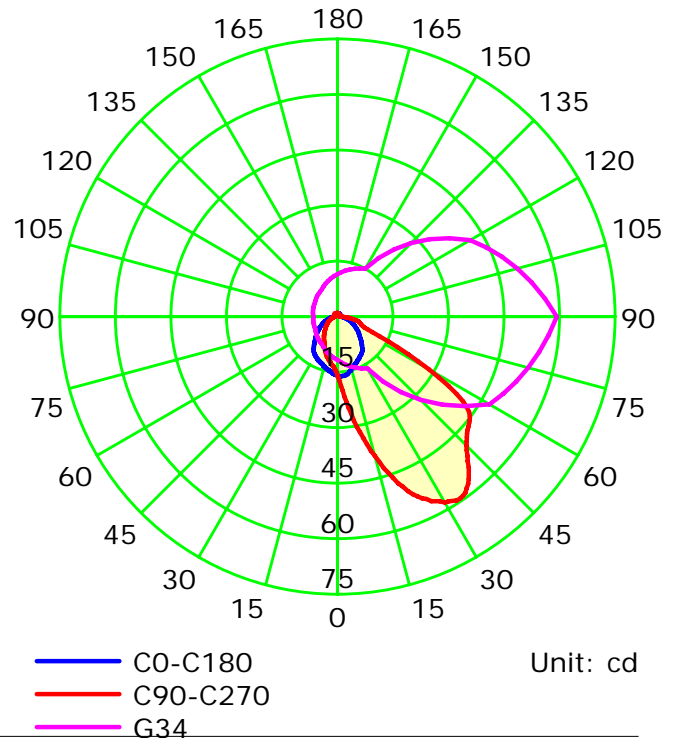

Test Lab: Leds-C4
 Test Type: TYPE C
 Temperature: 21.6
 Operator:

Test Device: GPM-1800
 Distance: 10.158 m
 Humidity: 57
 Inspector:

Coefficients Of Utilization - Zonal Cavity Method

RC	0.8	0.8	0.8	0.8	0.7	0.7	0.7	0.7	0.5	0.5	0.5	0.3	0.3	0.3	0.1	0.1	0.1	0
RW	0.7	0.5	0.3	0.1	0.7	0.5	0.3	0.1	0.5	0.3	0.1	0.5	0.3	0.1	0.5	0.3	0.1	0
RCR	RF = 0.2																	
0	50	50	50	50	48	48	48	48	45	45	45	43	43	43	40	40	40	39
1	45	43	42	40	44	42	41	39	40	38	37	38	37	36	36	35	34	33
2	41	38	35	33	40	37	34	32	35	33	31	33	31	30	31	30	29	28
3	38	33	30	27	36	33	29	27	31	28	26	29	27	25	28	26	24	23
4	35	30	26	23	33	29	26	23	27	25	22	26	24	22	25	23	21	20
5	32	27	23	20	31	26	22	20	25	22	19	23	21	19	22	20	18	17
6	29	24	20	17	28	23	20	17	22	19	17	21	19	16	20	18	16	15
7	27	22	18	15	26	21	18	15	20	17	15	19	17	15	18	16	14	13
8	25	20	16	14	24	19	16	14	18	15	13	18	15	13	17	15	13	12
9	24	18	15	12	23	18	14	12	17	14	12	16	14	12	16	13	11	11
10	22	17	13	11	21	16	13	11	16	13	11	15	12	11	14	12	10	10

Spacing Criteria (0-180): 1.15
 Spacing Criteria (90-270): 2.19
 Spacing Criteria (Diagonal): 1.55

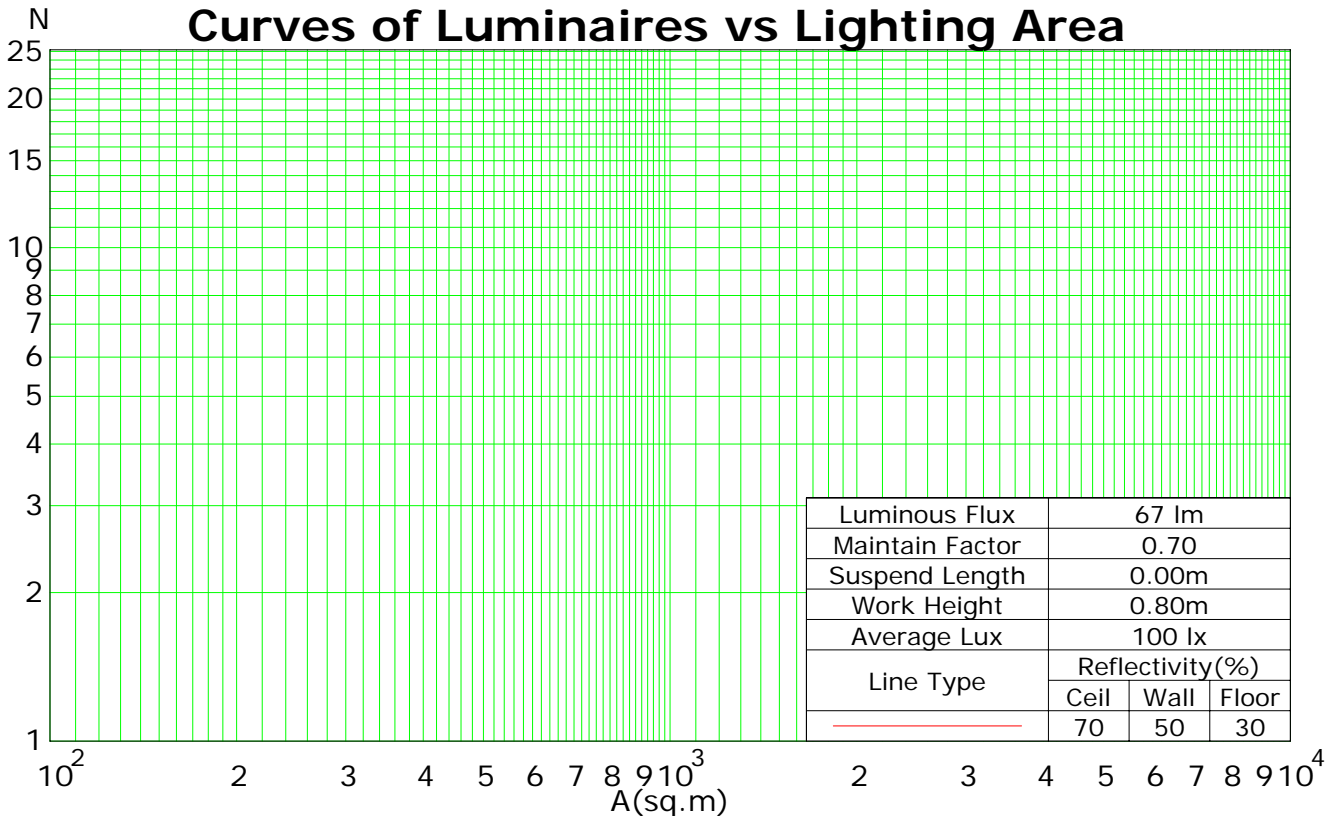

Test Lab: Leds-C4
 Test Type: TYPE C
 Temperature: 21.6
 Operator:

Test Device: GPM-1800
 Distance: 10.158 m
 Humidity: 57
 Inspector:

IsoLux Plot

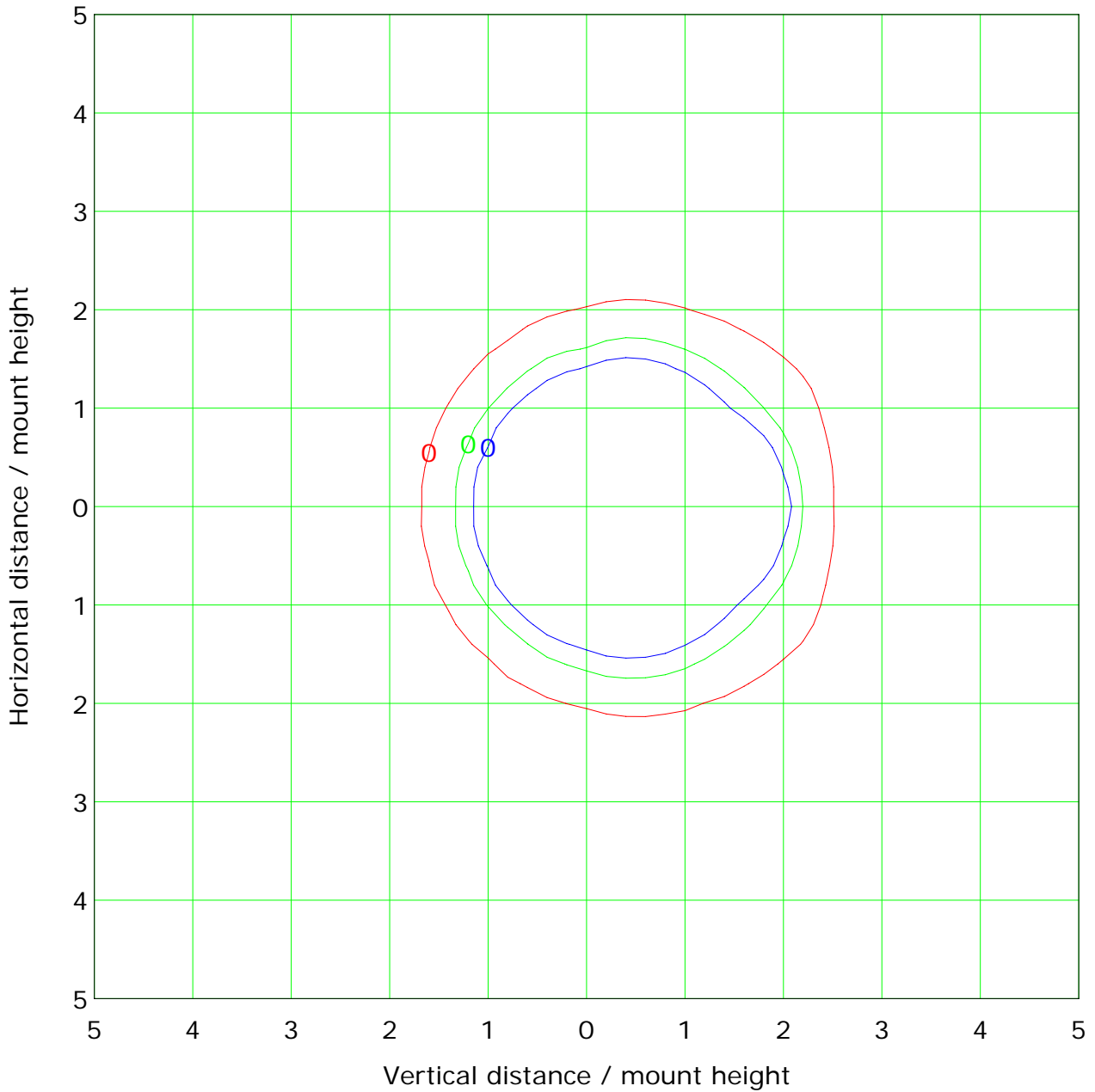

Mounting Height: 535m Max Lux(100%): 0 lx
 — (1%): 0 lx — (2%): 0 lx
 — (3%): 0 lx

Lum Limit Curve

Dazzle	Quality	Illuminance (lx)							
		2000	1000	500	<=300				
1.15	A								
1.50	B								
1.85	C								
2.20	D								
2.55	E								

a b c d e f g h

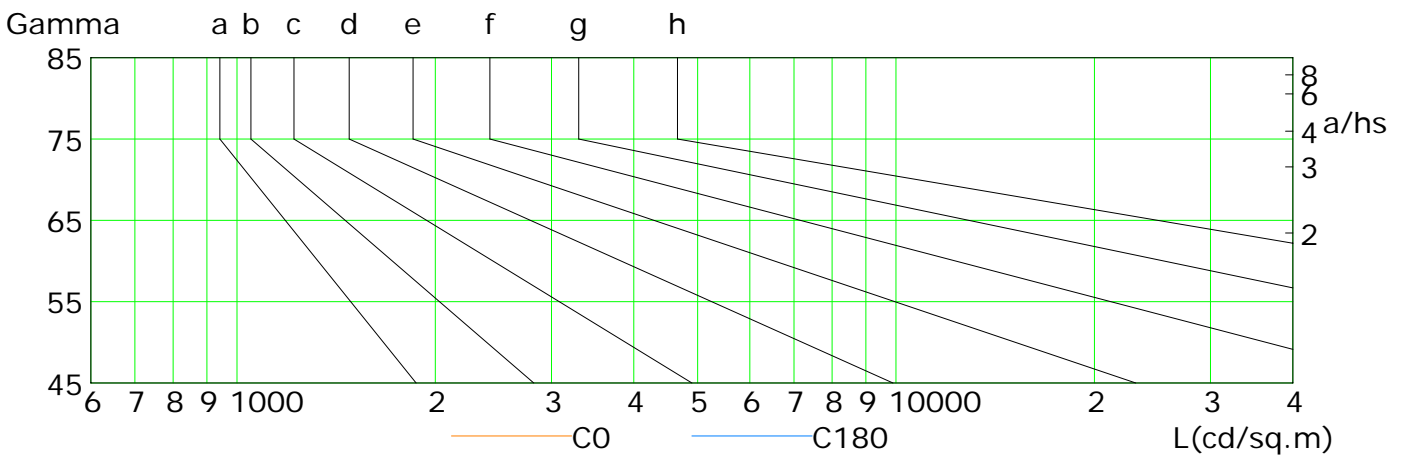
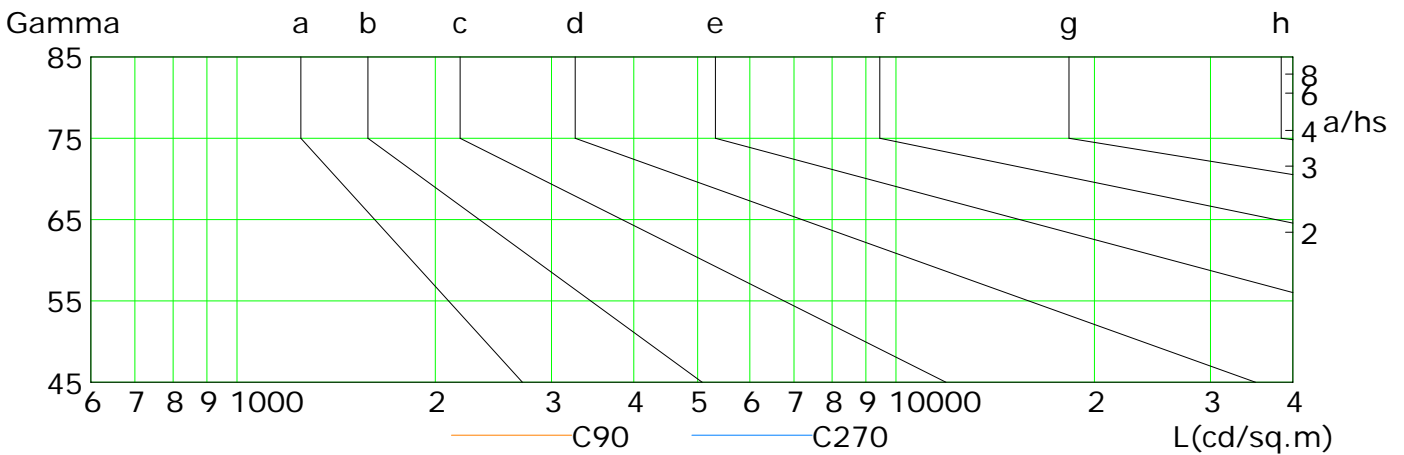

L(cd/sq.m)	G45	G50	G55	G60	G65	G70	G75	G80	G85
C0	9	8	7	6	5	4	3	2	1
C90	49	46	43	29	13	7	6	5	3
C180	8	7	6	5	4	4	3	2	1
C270	5	4	3	3	2	2	2	1	1

Test Lab: Leds-C4
 Test Type: TYPE C
 Temperature: 21.6
 Operator:

Test Device: GPM-1800
 Distance: 10.158 m
 Humidity: 57
 Inspector:

Illuminance at a Distance

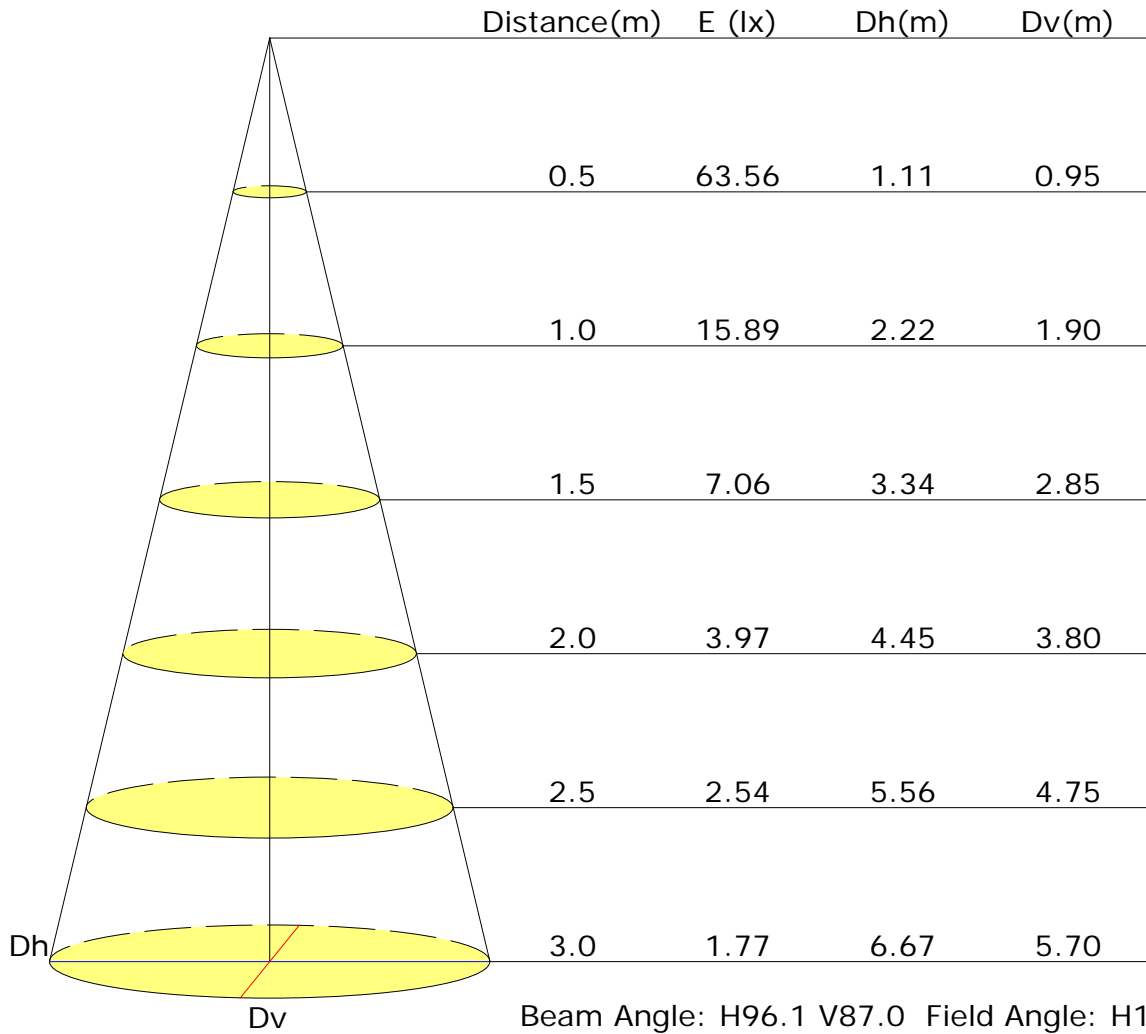

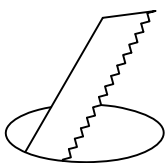
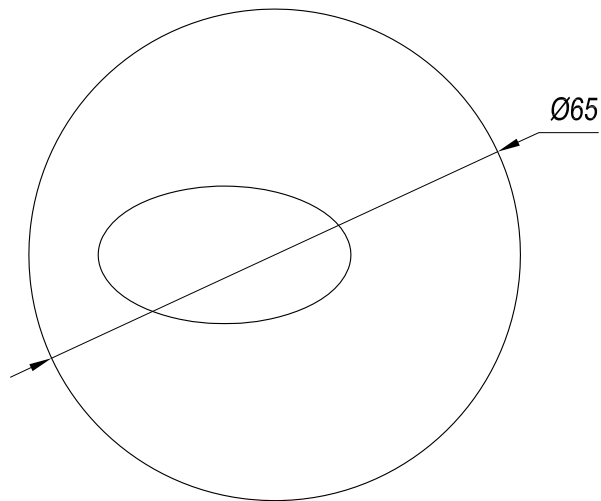
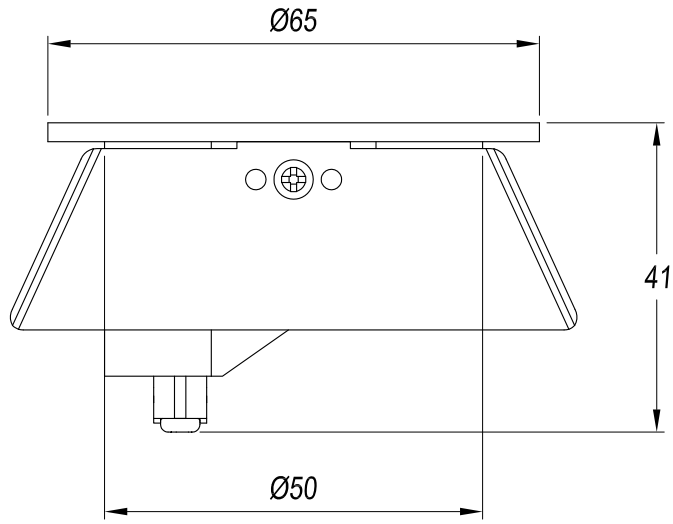

$\text{Ø}57$ mm

Scale 1:1

22-11-12

REF.	LAMP	VOLTAGE
55-1573-14-00	LED 3000K	220V
55-1573-N3-00	LED 3000K	220V
55-1574-14-00	LED 3000K	220V
55-1574-N3-00	LED 3000K	220V
55-1699-14-00	LED 3000K	110V
55-1699-N3-00	LED 3000K	110V
55-1701-14-00	LED 3000K	110V
55-1701-N3-00	LED 3000K	110V

NO DRIVER

220V

110V

NO DRIVER

