

55-9557-Z5-CLV0

MÜLLER Beacon

Designer: Francesc Vilaró

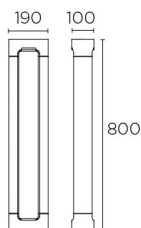

Description

Bollard for outdoor use.

For downlighting. Structure material: Extruded aluminium. Structure finish: Urban grey. Diffuser material: Polycarbonate. Diffuser finish: Matt. UV protection. Warranty: 2 Years. Ta max: 50°C.

Finish

Urban grey
Matt

Material

Extruded aluminium
Polycarbonate



TECHNICAL CHARACTERISTICS

Light source

Light source: LED BRIDGELUX
Output (W): 8.7W
Total power consumption (W): 12.1W
Color temperature: Warm White - 3000K
CRI: 80
Real Lumen: 203
Qty Leds: 1
Lm/Real W: 17
Life Time: 36.000h L90B10
UGR: 12.3

GEAR

Brand: MEANWELL
Gear included: Yes, electronic
Voltage / Frequency:
100-240VAC/50-60Hz
Power Factor: 0.48

Luminaire

Double cable exit: No
Drainage: No
Uv Protection: Yes
Warranty: 2 Years
Ta max: 50°C

Logistics

Energy Efficiency: LED A++
EAN Code: 8435381421069
Net Weight (Kg): 3.565
Weight in Kg (packaged): 4.268
Packing: 190 x 110 x 810
Masterbox: 2

The photograph may not match the reference exactly. Please read the product description to identify the finish.

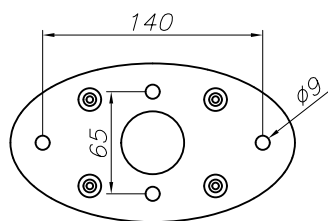
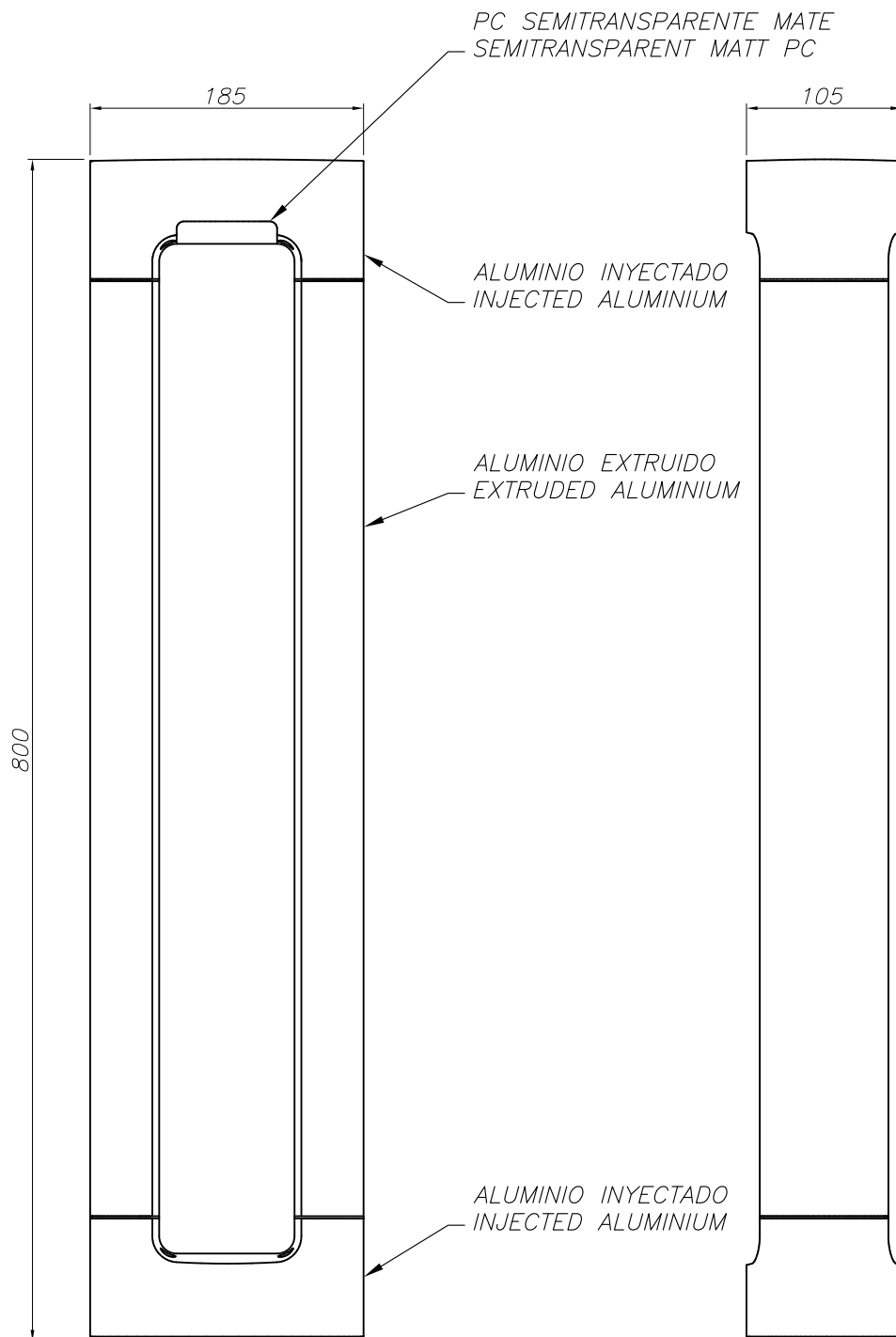

PLANTILLA DE INSTALACIÓN
INSTALLATION TEMPLATE

